

I LCM42002002 REV A ECN 1453

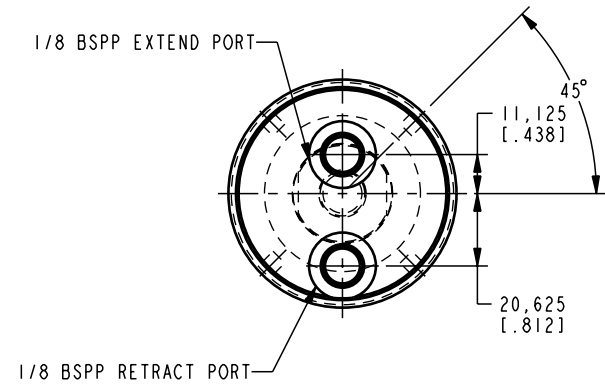

CAD CONTROL DRAWING

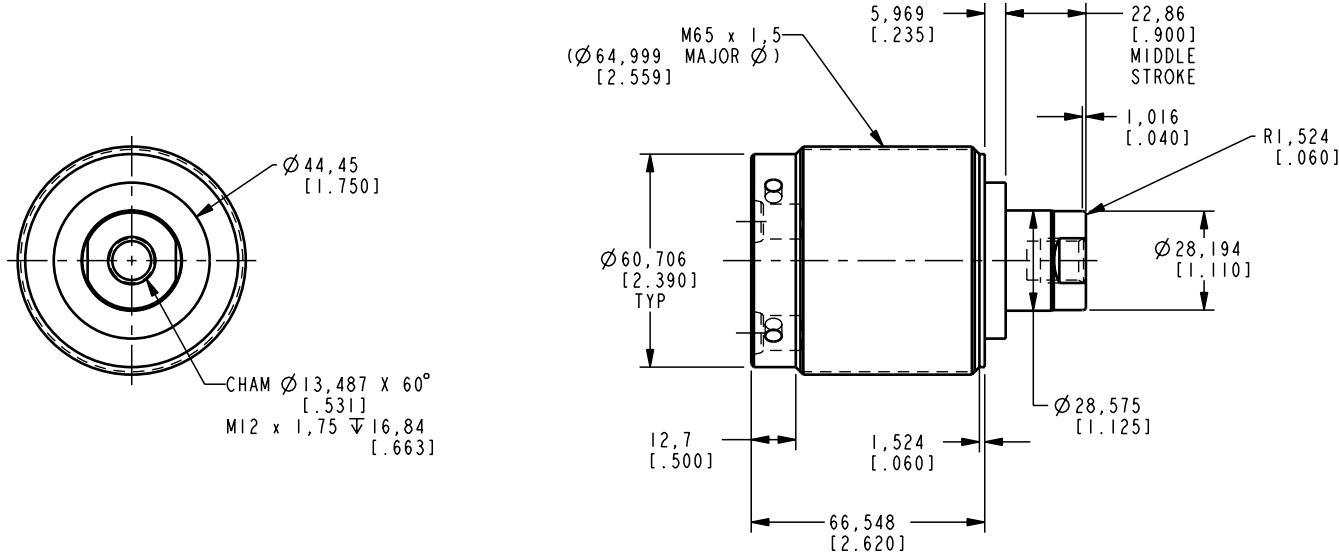

VEKTEK, INC.  
1334 E. SIXTH AVE. P.O. BOX 625  
EMPORIA, KS. 66801 U.S.A.

REV	A	1453	RELEASE	K. ROEMER	03-13-06	42002002	A	CYL, TB, 39.9 KN, 25.5 STRK, DA
REV	IN ACCORDANCE WITH ECN		EFFECTIVE DATE	REVISED BY	DATE	REFERENCE MODEL	REF REV	''''
DRW BY:	K. ROEMER		DRAWING STATUS: <b>Released</b>			TOLERANCES DO NOT APPLY	UNITS	SIZE
DATE:	03-13-06		PRODUCTION APPROVED FOR RELEASED STATUS ONLY			DIMENSIONS ARE NOMINAL	mm [inch]	D
							I LCM42002002	REV A

FORM FEG036, Rev. B