

1

2

REPLACING THE FACE SEAL:

1. The Coupling Mechanisms (2) are designed so that the face seal (1) can be replaced without having to removed the Mechanism (2) from its cavity.
2. Using a scribe or a sharp pick, pull the old face seal (1) out from the pilot groove.
3. Insert the new face seal (1) into the tip of the Seal Mounting Tool (P/N: AT-5603-00).
4. Taking the Seal Mounting Tool (P/N: AT-5603-00) in your hand, press the face seal (1) until it's flush in the pilot groove, keeping the Seal Mounting Tool (P/N: AT-5603-00) axially aligned to the Mechanism (2).

B

B

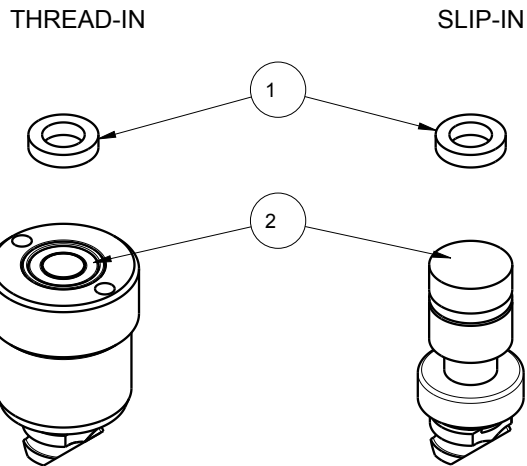

A

A

INSTALLATION INSTRUCTIONS



VEKTEK, INC.
 1334 E. SIXTH AVE. P.O. BOX 625
 EMPORIA, KS. 66801 U.S.A.

B	3077	RELEASE	TWA	10/26/16
REV	IN ACCORDANCE WITH ECN	EFFECTIVE DATE	REVISED BY	DATE
DRW BY: TWA		DRAWING STATUS: Released		
DATE: 8/19/16		PRODUCTION APPROVED FOR RELEASED STATUS ONLY		

ASSEMBLIES AFFECTED
 45-6101-30 45-6201-30
 45-6102-30 45-6202-30

INSTRUCTION SHEET, COUPLING ELEMENTS, ND3	
SIZE A	ISM5633
REV B	

1

2

SHEET 1 OF 1