

1

2

### REPLACING THE FACE SEAL:

1. The Coupling Mechanisms (2) are designed so that the face seal (1) can be replaced without having to removed the Mechanism (2) from its cavity.
2. Using a scriber or a sharp pick, pull the old face seal (1) out from the pilot groove.
3. Insert the new face seal (1) into the tip of the Seal Mounting Tool (P/N: AT-5605-00).
4. Taking the Seal Mounting Tool (P/N: AT-5605-00) in your hand, press the face seal (1) until it's flush in the pilot groove, keeping the Seal Mounting Tool (P/N: AT-5605-00) axially aligned to the Mechanism (2).

B

B

THREAD-IN

SLIP-IN

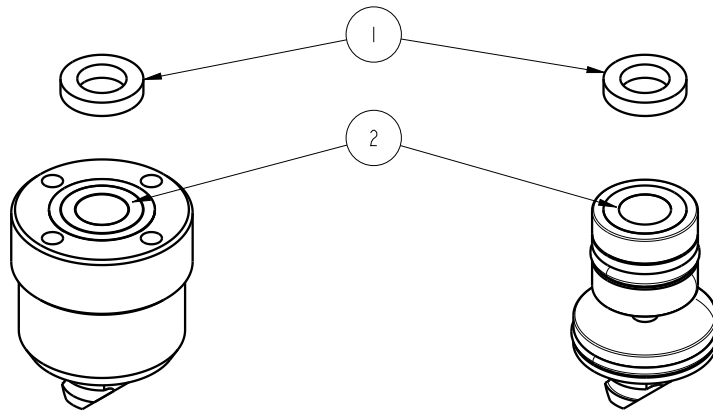

A

A

### INSTALLATION INSTRUCTIONS



VEKTEK, INC.  
 1334 E. SIXTH AVE. P.O. BOX 625  
 EMPORIA, KS. 66801 U.S.A.

A	3077	RELEASE	TWA	8/19/16
REV	IN ACCORDANCE WITH ECN	EFFECTIVE DATE	REVISED BY	DATE
DRW BY:	TWA	<b>DRAWING STATUS: Design</b>		
DATE:	8/19/16	PRODUCTION APPROVED FOR RELEASED STATUS ONLY		

ASSEMBLIES AFFECTED
45-6101-50 45-6201-50 45-6102-50 45-6202-50

INSTRUCTION SHEET, COUPLING ELEMENTS, NDS	
SIZE A	ISM5634
REV A	

1

2

SHEET 1 OF 1