

Ø8.0 X 3.0 O-RING / MANIFOLD UNCLAMP PORT

Ø146,05  
[5.750]

2X 23,00  
[0.906]

Ø8.0 X 3.0 O-RING / MANIFOLD CLAMP PORT

2X 54,00  
[2.126]

115,50  
[4.547]

51,50  
[2.028]

2X 6,00 X 45°  
[0.236]

103,00  
[4.055]

51,50  
[2.028]

29,00  
[1.142]

Ø94,77  
[3.731]

Ø59,25  
[2.333]

30°

234,75  
[9.242]  
MIDDLE  
VERTICAL  
CLAMPING  
STROKE

148,00  
[5.827]

1/4 BSPP UNCLAMP PORT

2X 20,00  
[0.787]

35,00  
[1.378]

68,50  
[2.697]

24,00  
[0.945]

2X 23,00  
[0.906]

1/4 BSPP CLAMP PORT 4X 41,50  
[1.634]

4X Ø12,80 THRU  
[0.504]

4X 41,50  
[1.634]

Ø20,00  
[0.787]

2X 54,00  
[2.126]

Ø8.0 X 3.0 O-RING / MANIFOLD CLAMP PORT

Ø8.0 X 3.0 O-RING / MANIFOLD UNCLAMP PORT

2X 23,00  
[0.906]

**CAD CONTROL  
DRAWING**



VEKTEK, INC.  
1334 E. SIXTH AVE. P.O. BOX 625  
EMPORIA, KS. 66801 U.S.A.

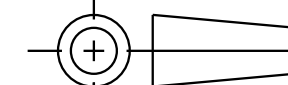

A	2714	RELEASE	MAJ	3-25-15	LI-4180-10-S-90	A	SC, BF, 7MPa, 80B, STR, CLEVIS, 90
REV	IN ACCORDANCE WITH ECN	EFFECTIVE DATE	REVISED BY	DATE	REFERENCE MODEL	REF REV	*****
DRW BY:	ALUTHI	DRAWING STATUS: <b>Released</b>			TOLERANCES DO NOT APPLY DIMENSIONS ARE NOMINAL	UNITS mm (inch)	SIZE D
DATE:	8-13-14	PRODUCTION APPROVED FOR RELEASED STATUS ONLY					ILCML1418010S90 REV A