

ILC14611820L REV A ECN 5873

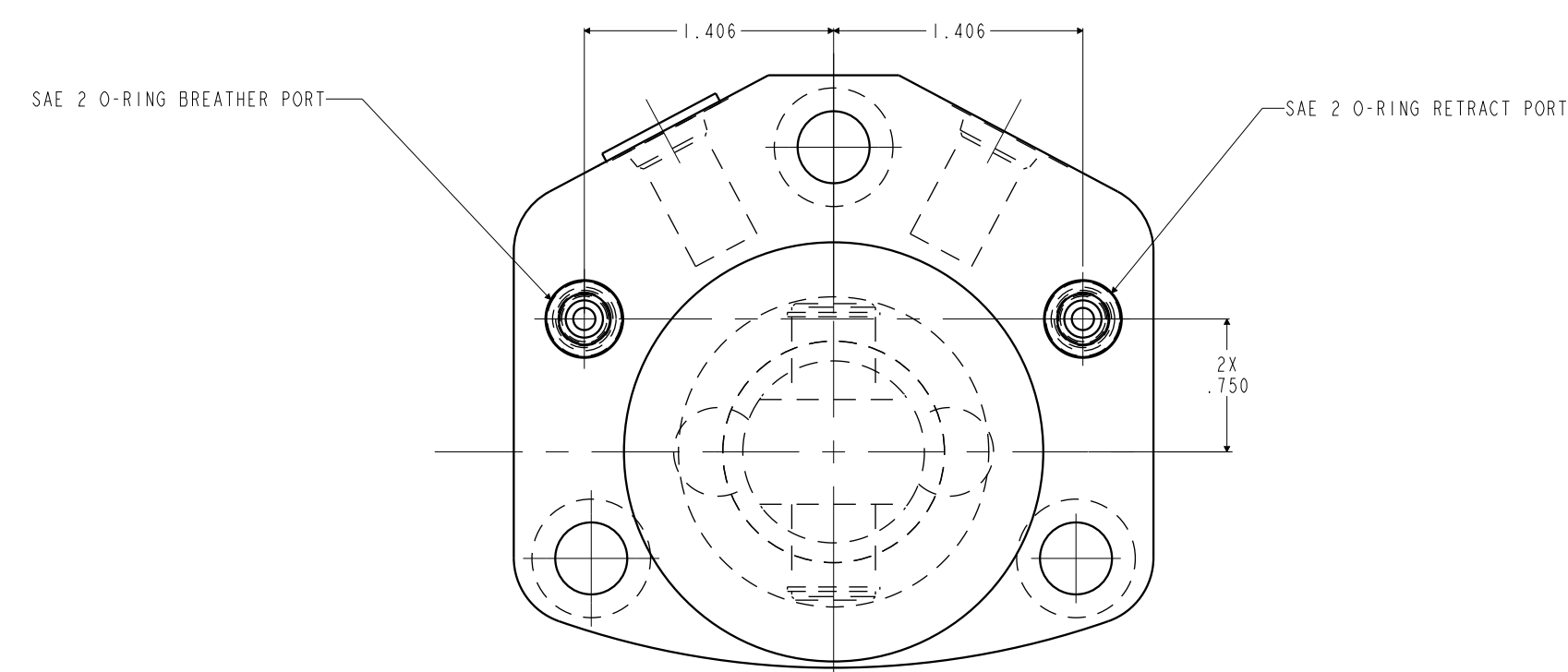

CAD CONTROL
DRAWING

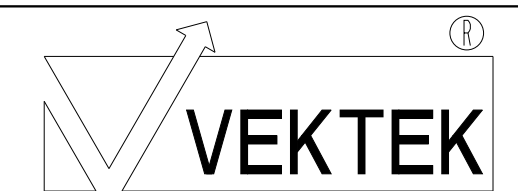

VEKTEK, INC.
1334 E. SIXTH AVE. P.O. BOX 625
EMPORIA, KS. 66801 U.S.A.

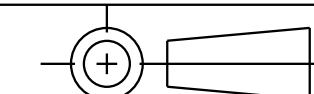

A	5873	RELEASE	JDW	01/16/26
REV	IN ACCORDANCE WITH ECN	EFFECTIVE DATE	REVISED BY	DATE
DRW BY:	JDW	DRAWING STATUS: Released		
DATE:	01/16/26	PRODUCTION APPROVED FOR RELEASED STATUS ONLY		

TOLERANCES DO NOT APPLY
DIMENSIONS ARE NOMINAL

SIZE D ILC14611820L REV A

FORM FEG036, Rev. B