

1

2

3

4

D

D

C

C

B

B

A

A

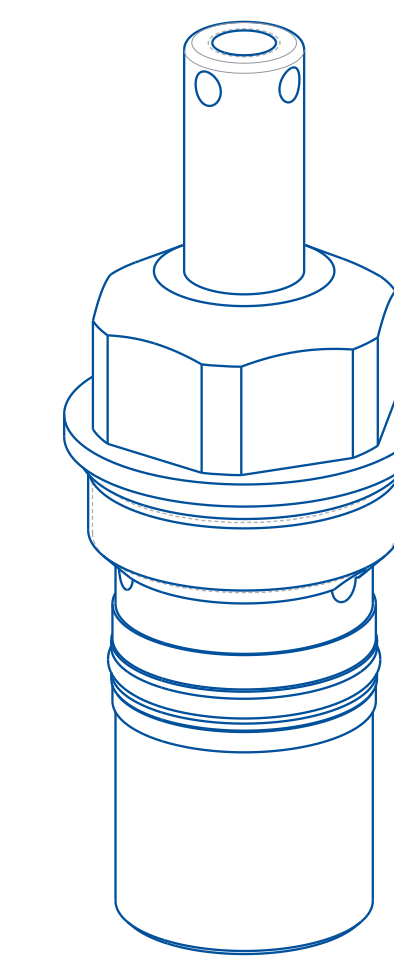
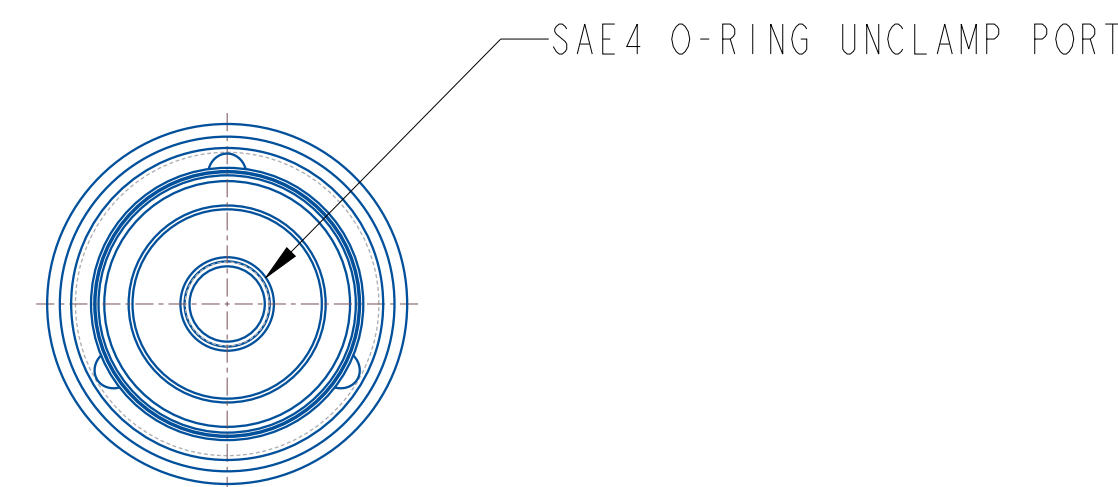
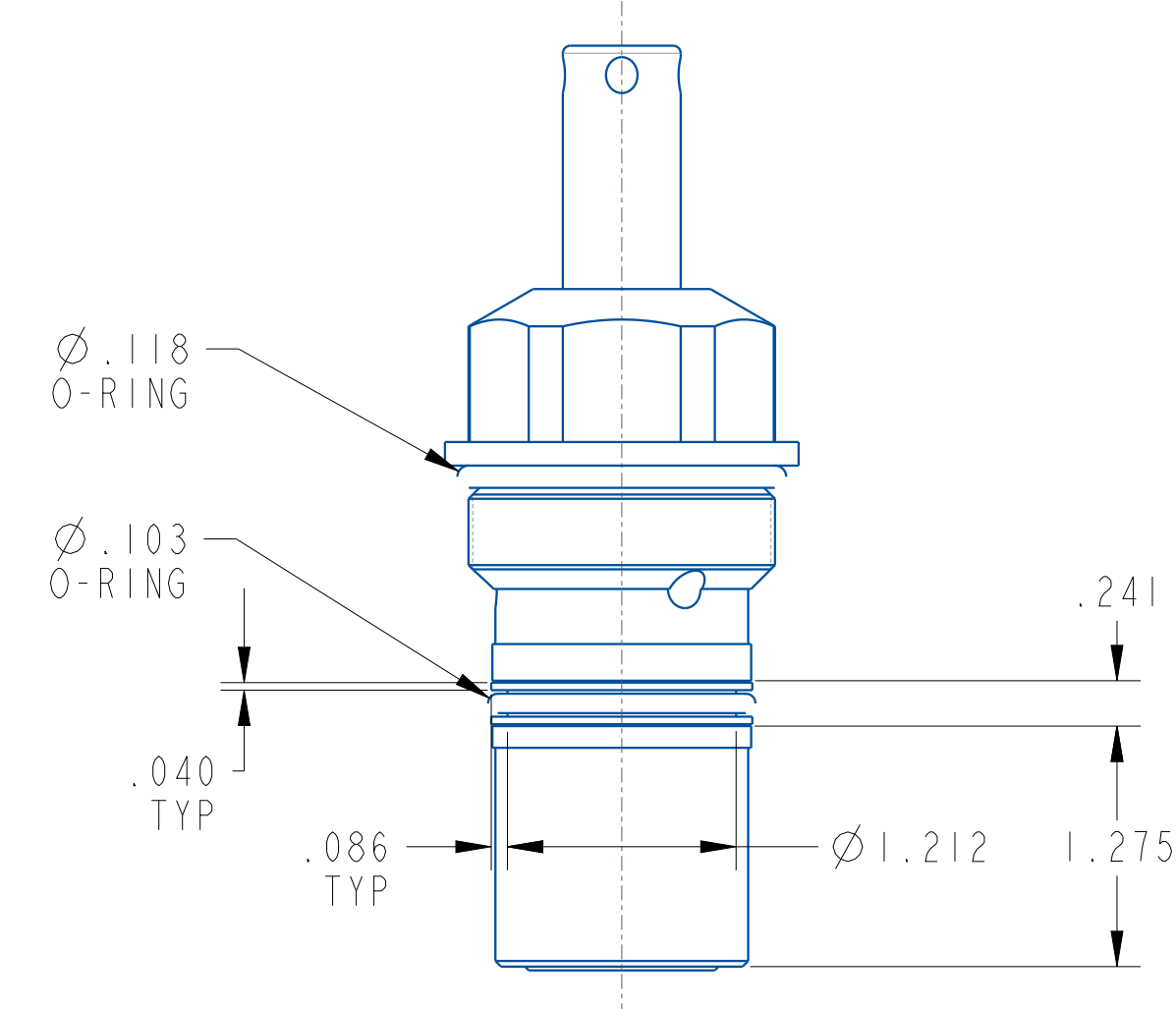
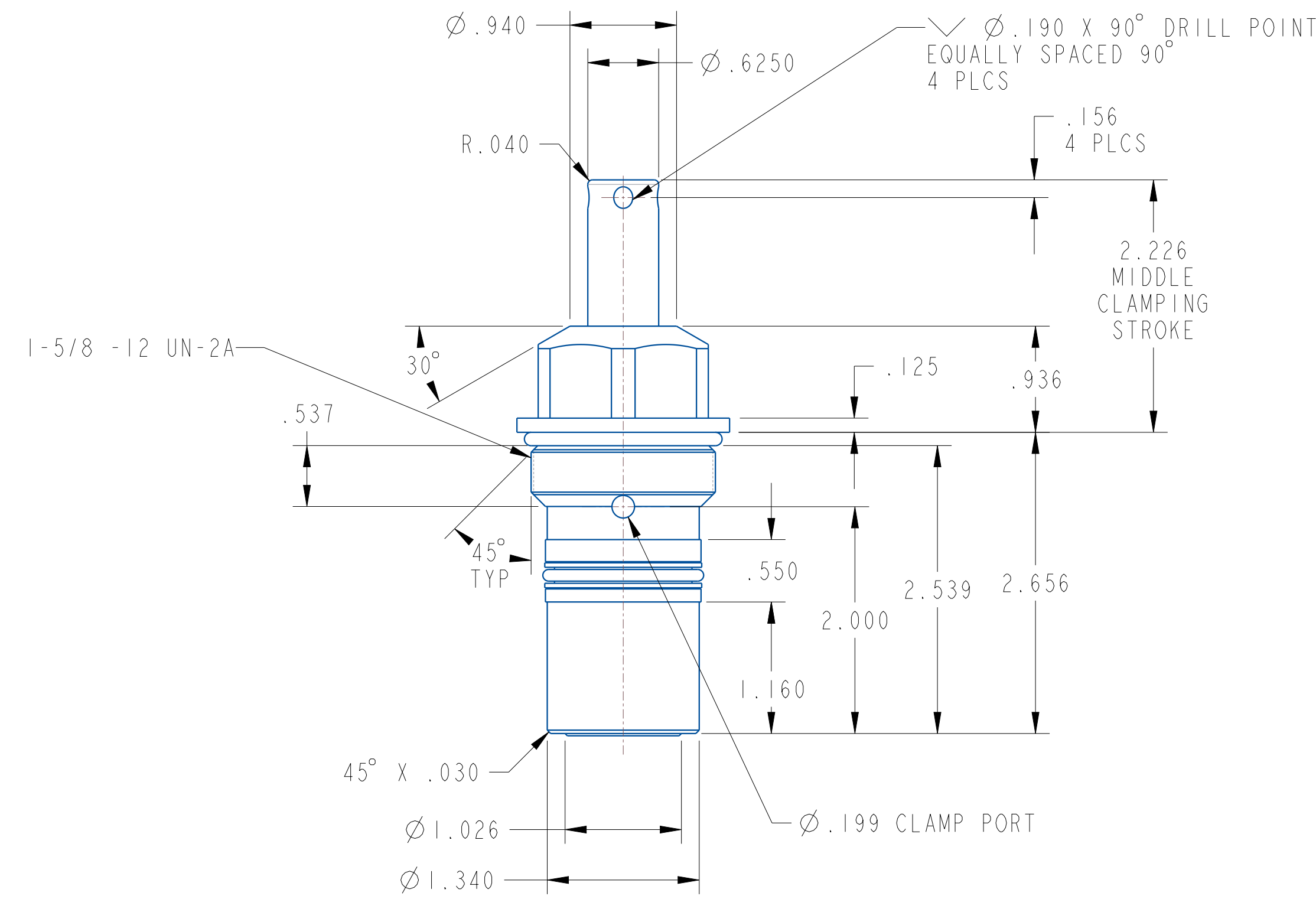
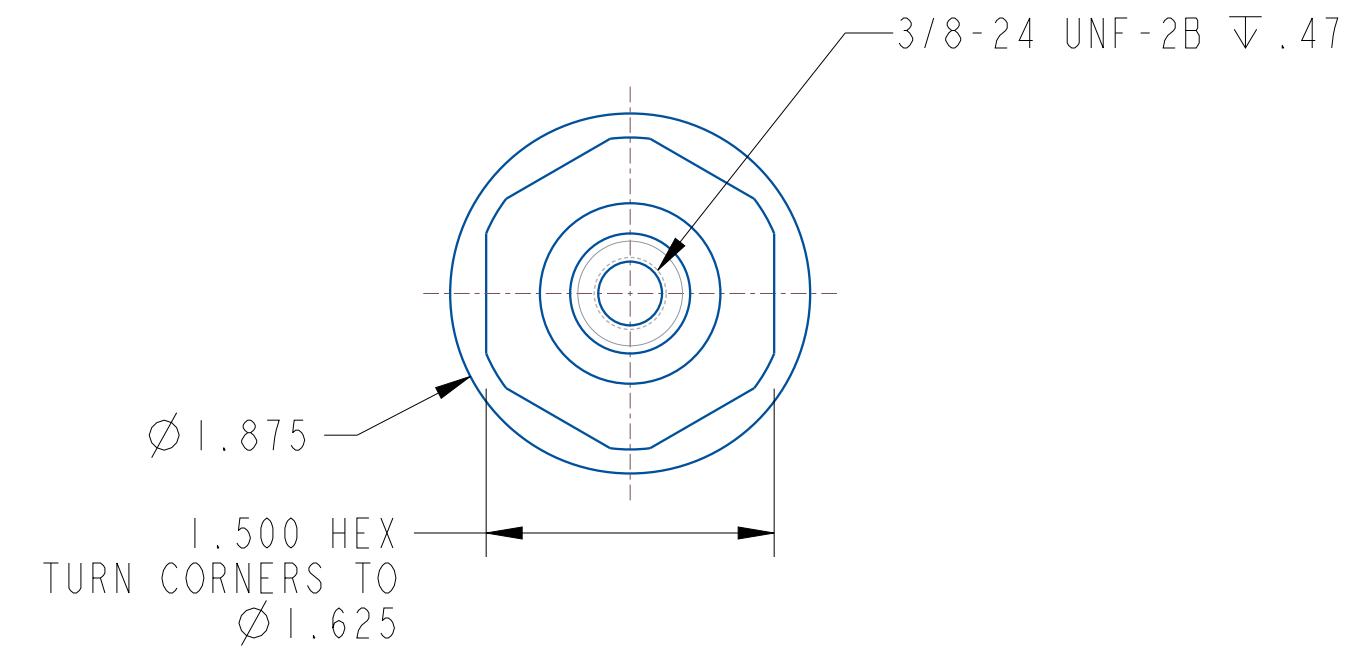

ILC15120902S REV A ECN5049

CAD CONTROL  
DRAWING



VEKTEK, INC.  
1334 E. SIXTH AVE. P.O. BOX 625  
EMPORIA, KS. 66801 U.S.A.

|         |                        |  |            |          |   |         |                       |
|---------|------------------------|--|------------|----------|---|---------|-----------------------|
| B       | 5049                   | RELEASED                                     | JDW        | 03/06/23 | 15120902S   | A       | SC, CM, 1100, DA, STR |
| REV     | IN ACCORDANCE WITH ECN | EFFECTIVE DATE                               | REVISED BY | DATE     | REFERENCE MODEL                                   | REF REV |                       |
| DRW BY: | ALS                    | DRAWING STATUS: Released                     |            |          | TOLERANCES DO NOT APPLY<br>DIMENSIONS ARE NOMINAL |         | SIZE D                |
| DATE:   | 5/17/21                | PRODUCTION APPROVED FOR RELEASED STATUS ONLY |            |          | ILC15120902S                                      |         | REV B                 |