

ILC55959500 REV A ECN 3111  
SCALE 0.500

CAD CONTROL  
DRAWING

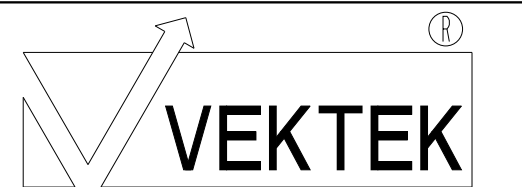

VEKTEK, INC.  
1334 E. SIXTH AVE. P.O. BOX 625  
EMPORIA, KS. 66801 U.S.A.

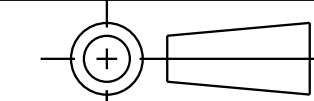

A	3111	RELEASE	KR	11/17/16	55959500	A	AY, AWP, 50, 1HP, 3P, 380-500V, 5G, NP
REV	IN ACCORDANCE WITH ECN	EFFECTIVE DATE	REVISED BY	DATE	REFERENCE MODEL	REF REV	*****
DRW BY:	KR	DRAWING STATUS: Released			TOLERANCES DO NOT APPLY		SIZE
DATE:	11/17/16	PRODUCTION APPROVED FOR RELEASED STATUS ONLY			DIMENSIONS ARE NOMINAL		D
							ILC55959500
							REV A