

ILC56000801 REV A ECN 3191

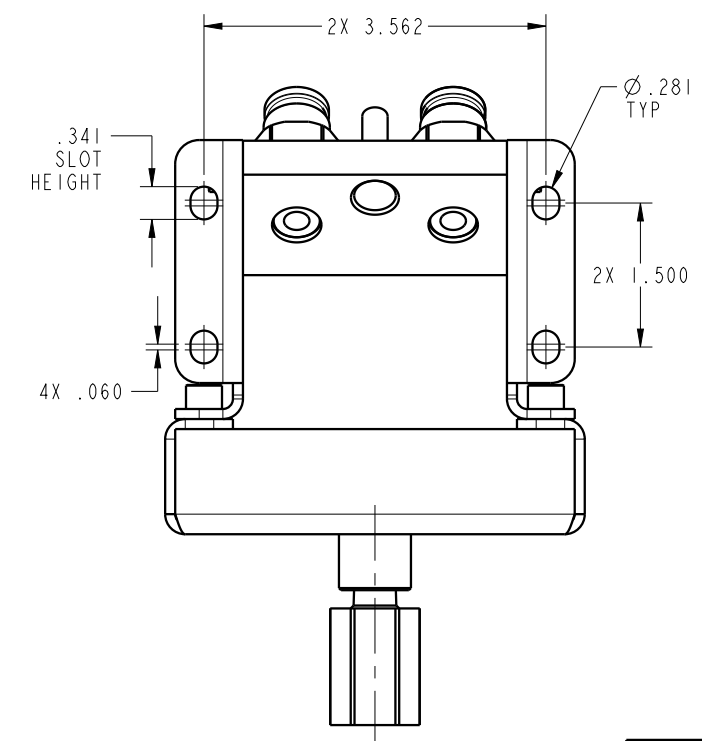
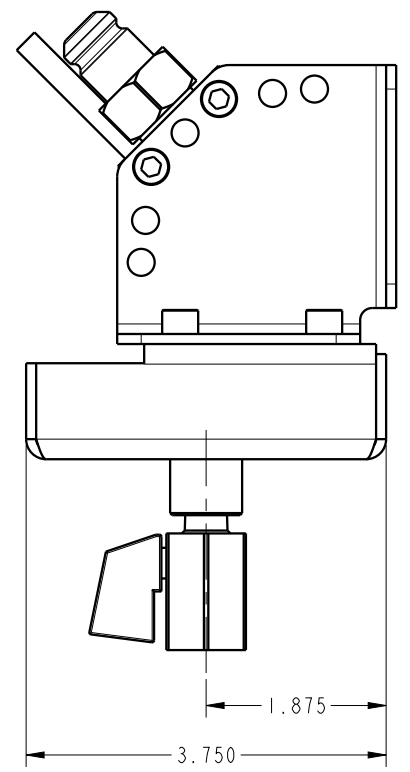
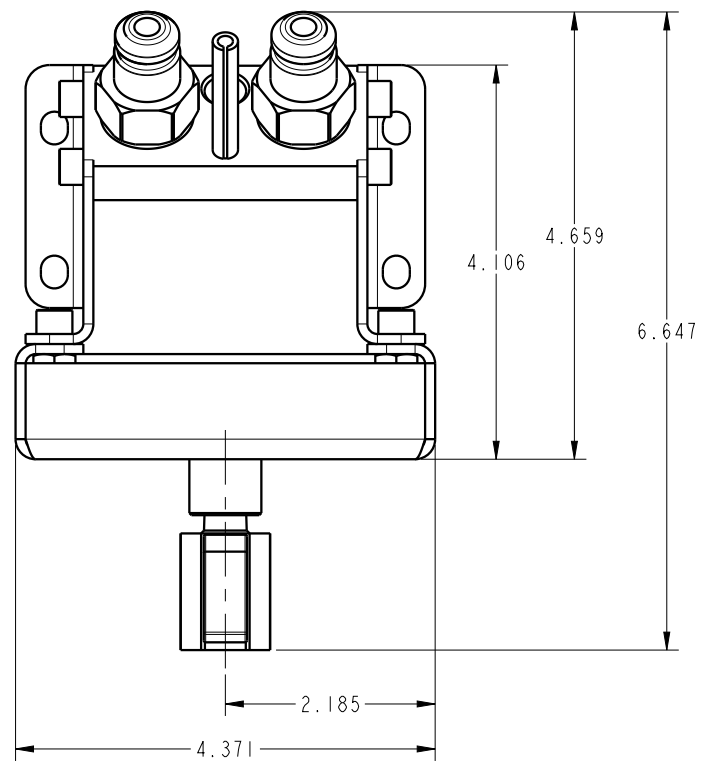

<b>CAD CONTROL DRAWING</b>				 VEKTEK, INC. 1334 E. SIXTH AVE. P.O. BOX 625 EMPORIA, KS. 66801 U.S.A.			
A	3191	RELEASE	MAJ	3/28/17	56000801	A	ASSY, DOCKING STATION, W/O PROX, IH
REV	IN ACCORDANCE WITH ECN	EFFECTIVE DATE	REVISED BY	DATE	REFERENCE MODEL	REF REV	*****
DRW BY: MAJ	<b>DRAWING STATUS: Released</b>				TOLERANCES DO NOT APPLY	SIZE	ILC56000801
DATE: 3/28/17	PRODUCTION APPROVED FOR RELEASED STATUS ONLY				DIMENSIONS ARE NOMINAL	B	REV A
							FORM FEG036, Rev. B