

ILC56000806, REV A, ECN 5059

**CAD CONTROL
DRAWING**

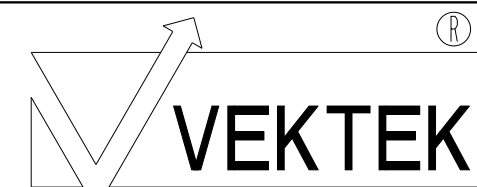

VEKTEK, INC.
1334 E. SIXTH AVE. P.O. BOX 625
EMPORIA, KS. 66801 U.S.A.

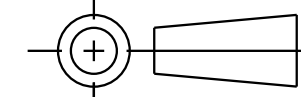

A	5059	RELEASE	JDW	03/25/23
REV	IN ACCORDANCE WITH ECN	EFFECTIVE DATE	REVISED BY	DATE
DRW BY: JDW		DRAWING STATUS: Released		
DATE: 03/25/23		PRODUCTION APPROVED FOR RELEASED STATUS ONLY		

MODEL NAME	A	ASSY, DOCKING STATION, QD TRIGGER COUPLER
REFERENCE MODEL	REF REV	
TOLERANCES DO NOT APPLY DIMENSIONS ARE NOMINAL		SIZE D

REV	ILC56000806	REV A
FORM FEG036, Rev. B		SHEET 1 OF 1