

PNEUMATIC PORT INFORMATION		
PORT#	TYPE	DESCRIPTION
P6	1/4 PUSH FITTING	SLIDE RETRACTION PORT
P7	1/4 PUSH FITTING	SLIDE EXTENSION PORT

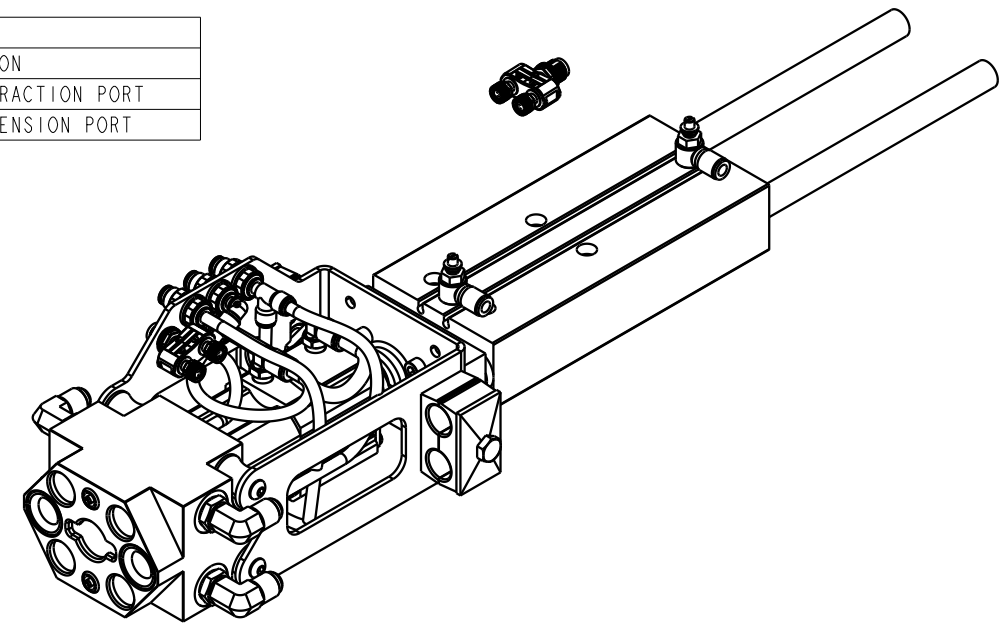

ILC56001011 REV A ECN#5109

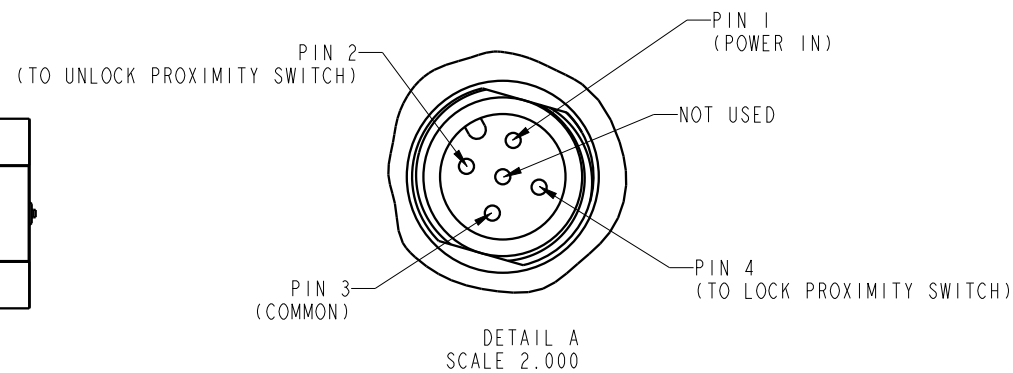
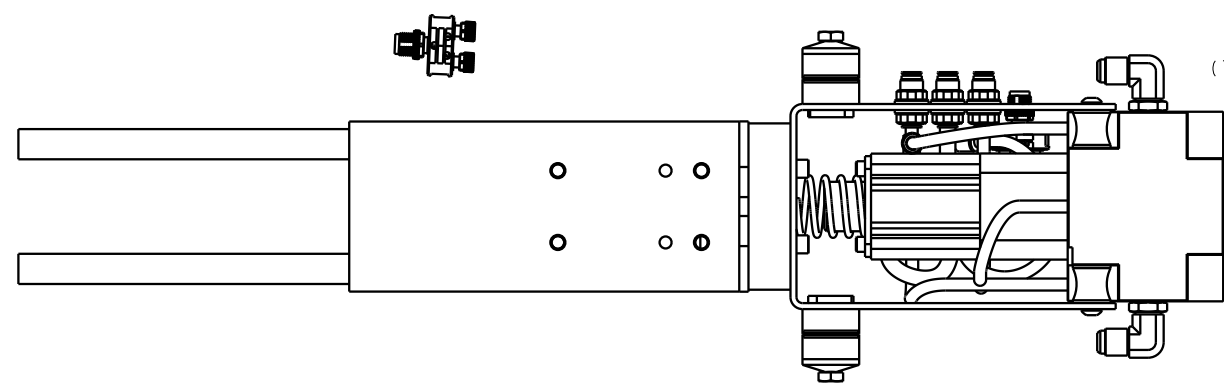
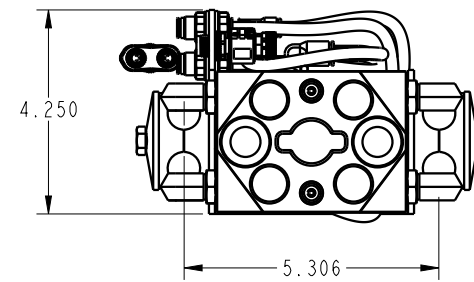
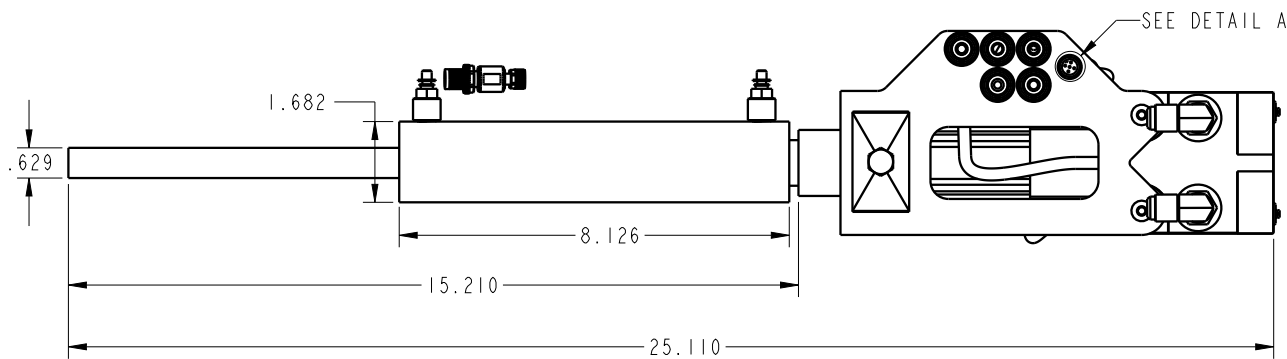
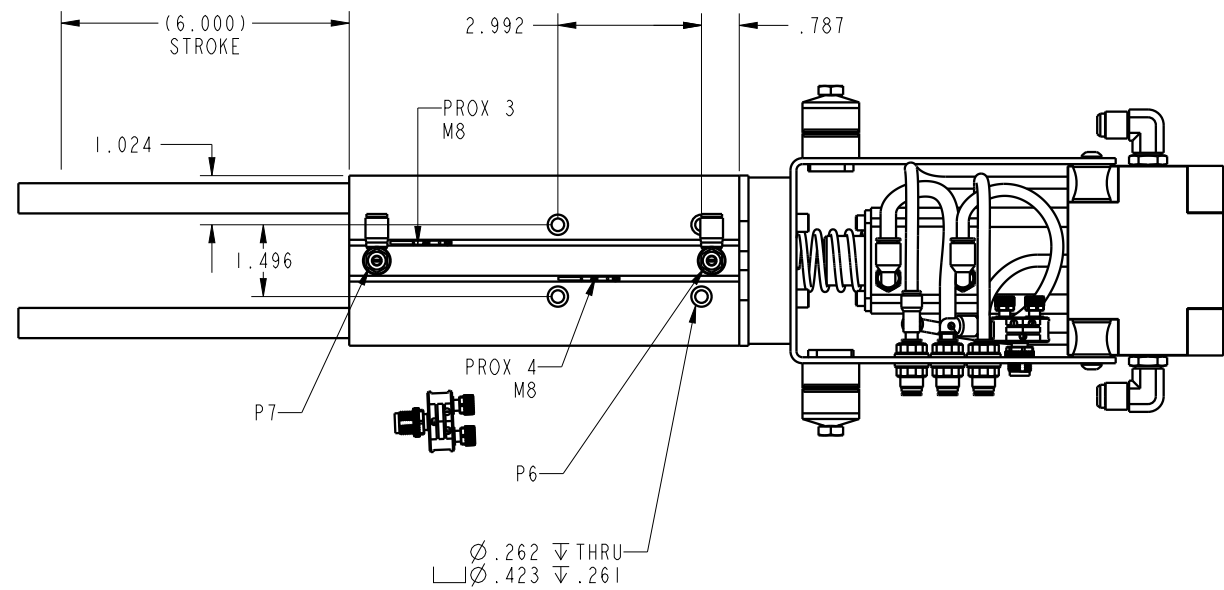

CAD CONTROL DRAWING



VEKTEK, INC.
1334 E. SIXTH AVE. P.O. BOX 625
EMPORIA, KS. 66801 U.S.A.

A	5109	RELEASE	BDC	7/31/23	ILC56001011	A	ILC, ASSY, AUTOCOUPLER, W/SLIDE, 6"
REV	IN ACCORDANCE WITH ECN	EFFECTIVE DATE	REVISED BY	DATE	REFERENCE MODEL	REF REV	
DRW BY:	BDC	DRAWING STATUS: Released			TOLERANCES DO NOT APPLY		SIZE
DATE:	7/31/23	PRODUCTION APPROVED FOR RELEASED STATUS ONLY			DIMENSIONS ARE NOMINAL		B

ILC56001011	A	ILC, ASSY, AUTOCOUPLER, W/SLIDE, 6"
ILC56001011	REV A	

FORM FEG036, Rev. B

SHEET 1 OF 1