

ILC91500903 REV B ECN 1568

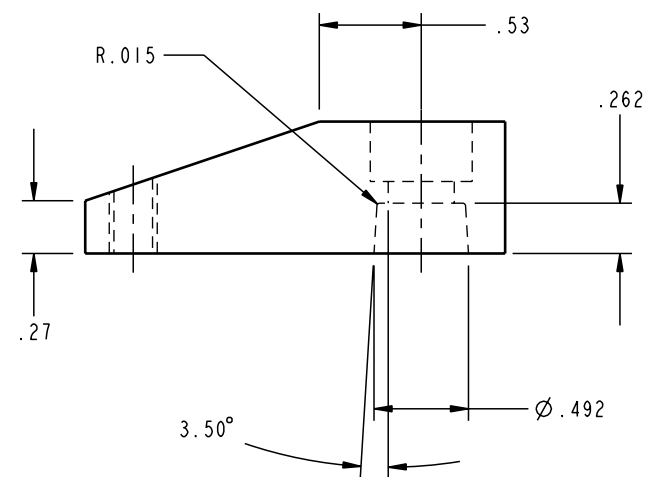

CAD CONTROL DRAWING			
		VEKTEK, INC. 1334 E. SIXTH AVE. P.O. BOX 625 EMPORIA, KS. 66801 U.S.A.	
B 1568	RELEASE	K. ROEMER	09-29-06
REV IN ACCORDANCE WITH ECN	EFFECTIVE DATE	REVISED BY	DATE
DRW BY: K. ROEMER	DRAWING STATUS: Released		91500903 D
DATE: 09-29-06	PRODUCTION APPROVED FOR RELEASED STATUS ONLY		ARM, SC, PNEU, 7/8, 1 1/8
TOLERANCES DO NOT APPLY DIMENSIONS ARE NOMINAL		SIZE B	ILC91500903 REV B
		FORM FEG036, Rev. A	

SHEET 1 OF 1