

ILC91520910 REV A ECN 739

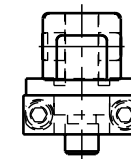

2	1	ILC91520909	ARM, SC, ROCKER, 1100
1	1	ILC91520908	ATCH, RKRA, 1100
No.	QTY	PART No.	DESCRIPTION

**CAD CONTROL  
DRAWING**

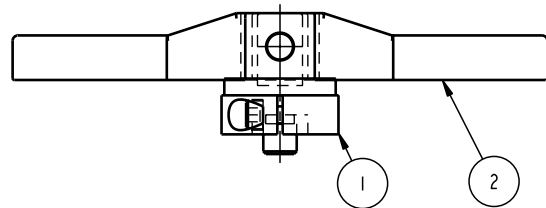

VEKTEK, INC.  
1334 E. SIXTH AVE. P.O. BOX 625  
EMPORIA, KS. 66801 U.S.A.



A	739	RELEASE	K. ROEMER	03-21-05	91520910	A	ASSY, RKRA, SC, 1100
REV	IN ACCORDANCE WITH ECN	EFFECTIVE DATE	REVISED BY	DATE	REFERENCE MODEL	REF REV	
DRW BY:	K. ROEMER	<b>DRAWING STATUS: Released</b>			TOLERANCES DO NOT APPLY		SIZE
DATE:	10/23/02	PRODUCTION APPROVED FOR RELEASED STATUS ONLY			DIMENSIONS ARE NOMINAL		D ILC91520910 REV A

FORM FEG036, Rev. A

SHEET 1 OF 1

1 2 3 4

D  
C  
B  
A

D  
C  
B  
A

1 2 3 4