

I LCM-VS-LL-300 REV A ECN 5364

**CAD CONTROL  
DRAWING**

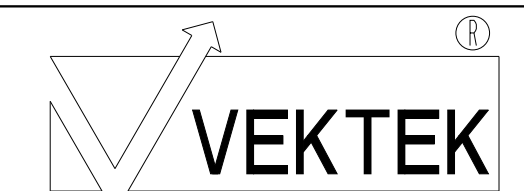

VEKTEK, INC.  
1334 E. SIXTH AVE. P.O. BOX 625  
EMPORIA, KS. 66801 U.S.A.

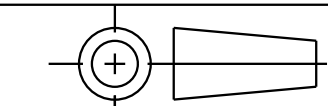

A	5364	RELEASE	AJT	7/3/24	VS-LL-300	A	GRIPPER, JAW, BLANK, 300, AL
REV	IN ACCORDANCE WITH ECN	EFFECTIVE DATE	REVISED BY	DATE	REFERENCE MODEL	REF REV	
DRW BY:	AJT	DRAWING STATUS: Released			TOLERANCES DO NOT APPLY	UNITS	SIZE
DATE:	7/3/24	PRODUCTION APPROVED FOR RELEASED STATUS ONLY			DIMENSIONS ARE NOMINAL	mm (inch)	D
					I LCM-VS-LL-300	REV	A