

I LCM4142222PS REV C ECN 4191

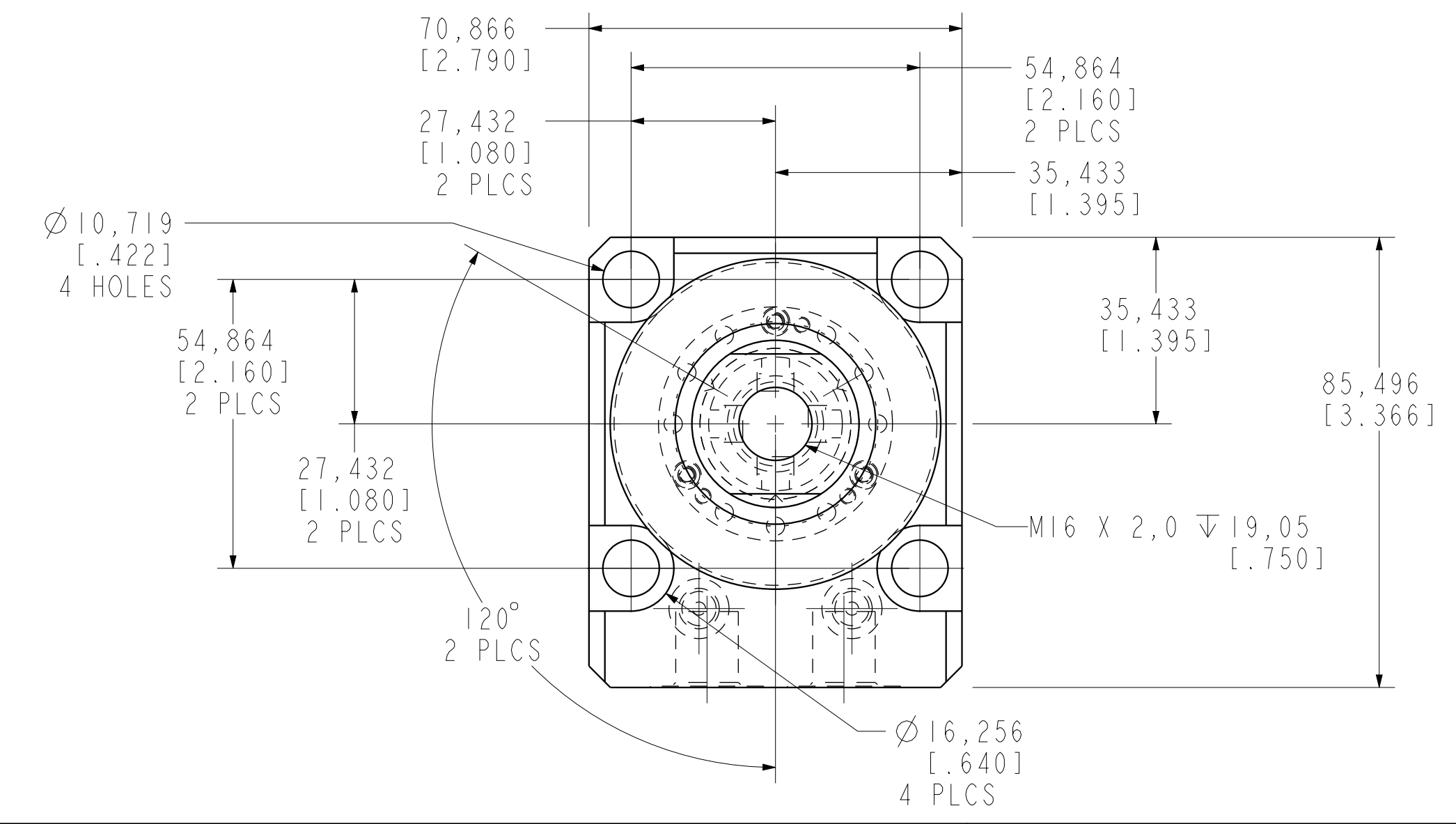

CAD CONTROL DRAWING				 VEKTEK, INC. 1334 E. SIXTH AVE. P.O. BOX 625 EMPORIA, KS. 66801 U.S.A.	
C	4191	RELEASE	JDW	05/22/20	4142222PS
REV	IN ACCORDANCE WITH ECN	EFFECTIVE DATE	REVISED BY	DATE	REFERENCE MODEL
DRW BY: JDW	DRAWING STATUS: Released				TOLERANCES DO NOT APPLY
DATE: 07/07/14	PRODUCTION APPROVED FOR RELEASED STATUS ONLY				UNITS
					SIZE
					D
					I LCM4142222PS
					REV C
					FORM FEG036, Rev. C