

I LCMVAP61025001 REV A ECN 5752

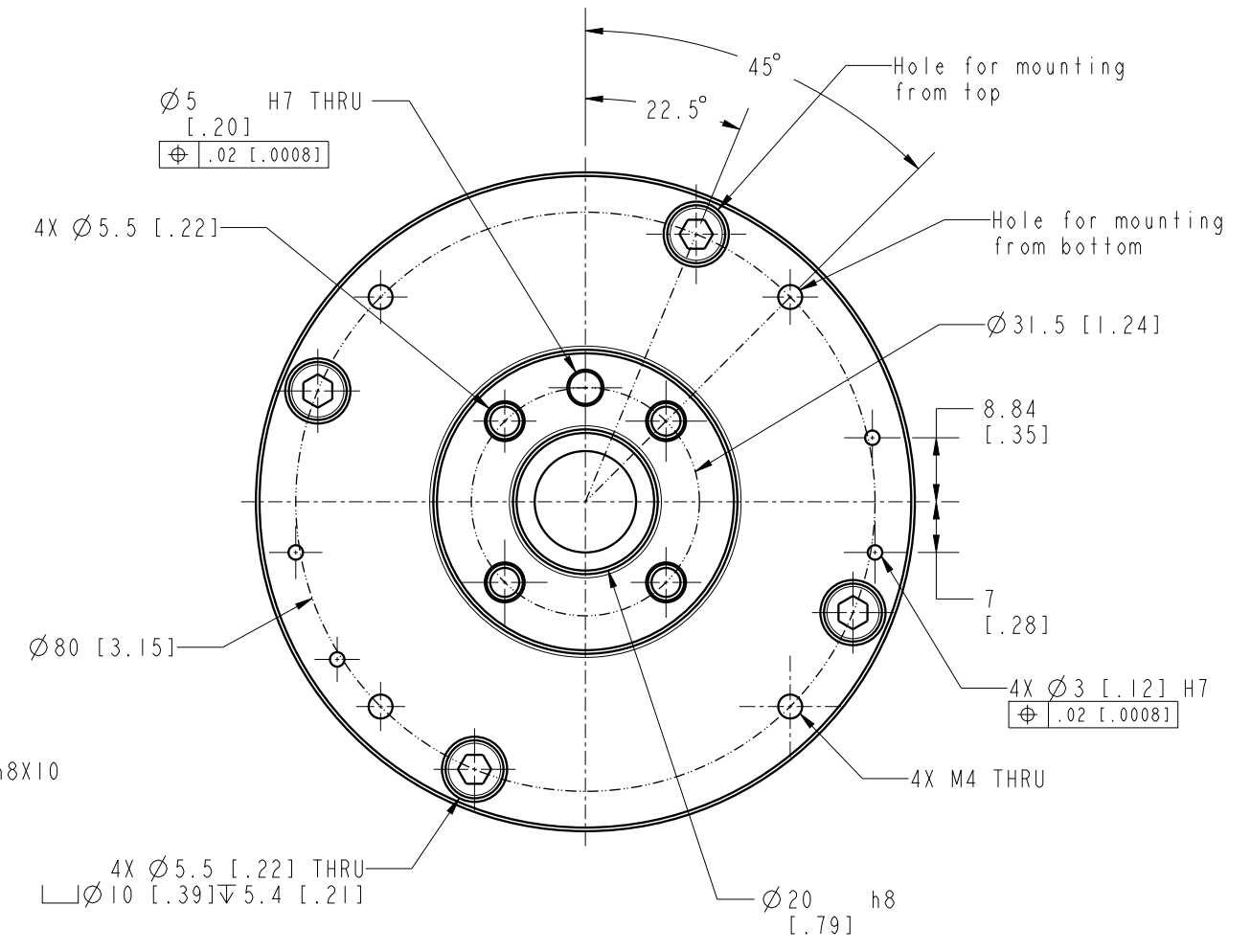
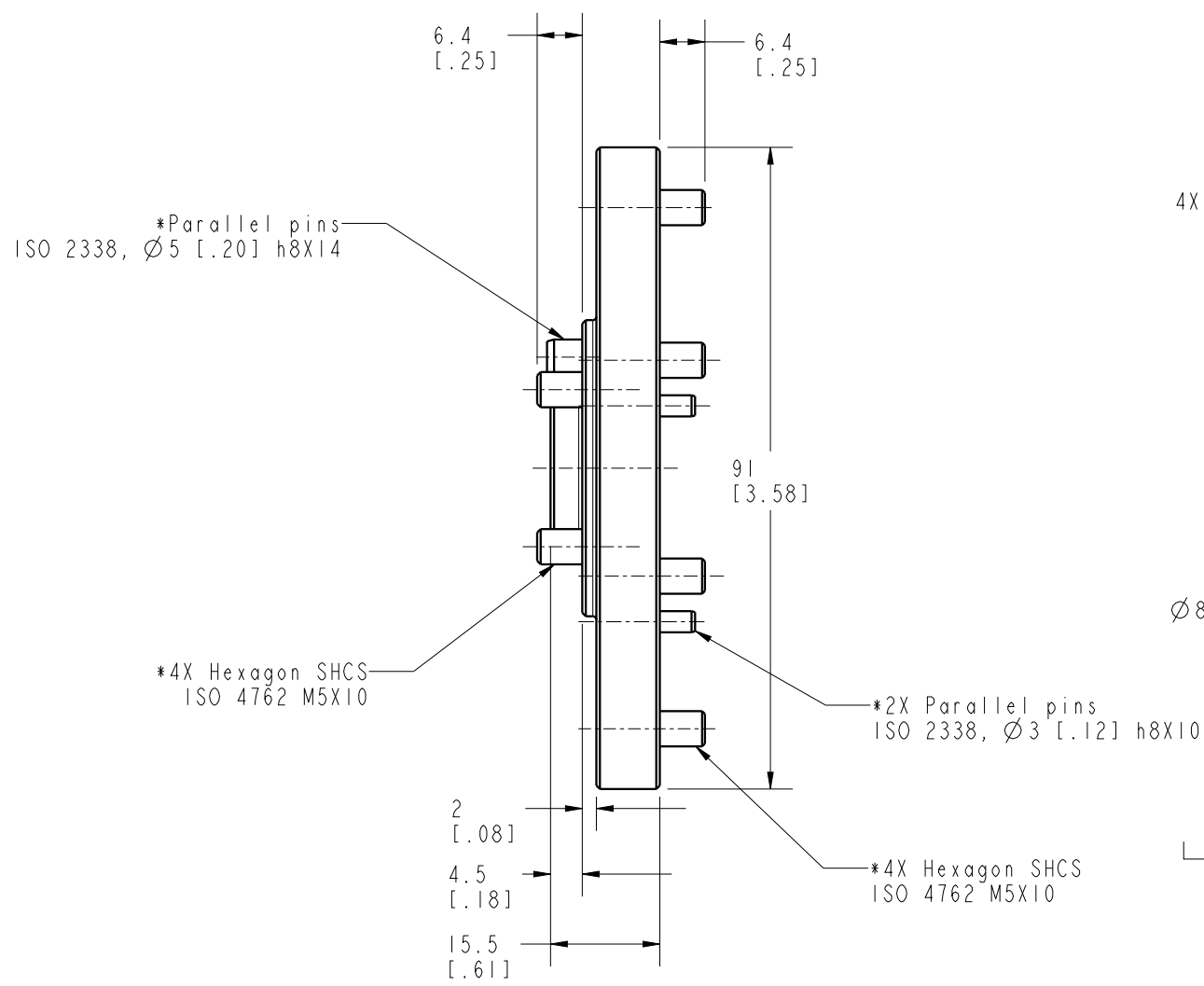

NOTES:
1. *Items are included

CAD CONTROL DRAWING			
		VEKTEK, INC. 1334 E. SIXTH AVE., P.O. BOX 625 EMPORIA, KS. 66801 U.S.A.	

A	5752	RELEASE	ALS	10/22/25	Vap61025001	A	IMPAOT, RC, PQ0, ISO-31.5
REV	IN ACCORDANCE WITH ECN	EFFECTIVE DATE	REVISED BY	DATE	REFERENCE MODEL	REF REV	
DRW BY:	ALS	DRAWING STATUS: Released			TOLERANCES DO NOT APPLY	UNITS	SIZE
DATE:	6/30/25	PRODUCTION APPROVED FOR RELEASED STATUS ONLY			DIMENSIONS ARE NOMINAL	mm [inch]	B
					I LCMVAP61025001	REV	A

FORM FEG036, Rev. C