

SECTION A-A

| NO | QTY | PART NO | DESCRIPTION | STD SEAL KIT |
|-----|-----|----------|--|--------------|
| 1 | 2 | 21500051 | SCREW, CAP, BTNH, M3 X 4, SSSL | |
| 2 | 2 | 21500319 | SCREW, SET, CUP PT, M6 X 1 X 12 | |
| 3 | 4 | 23050034 | RING, RTNG, EXT, 0.312 | X |
| 4 | 8 | 23050035 | RING, RTNG, EXT, 0.354 | X |
| 5 | 1 | 39051185 | O-RING (-022), 1 X 1/16 X 1-1/8 | X |
| 6 | 1 | 39051186 | O-RING (-031), 1-3/4 X 1/16 X 1-7/8 | X |
| 7 | 1 | 39052061 | SEAL, ROD, RSD, 18, 85A, AU | X |
| 8 | 1 | 39053042 | SEAL, WIPER, SNAP IN, WED, 18, 94A, AU | X |
| 9 | 1 | 39056033 | SEAL, CAP, PISTON, 22.5, 94A, AU | X |
| 10 | 4 | 81600147 | LINK, LC, 7MP α , 40B | |
| 11 | 4 | 81600152 | PIN, LINK, LC, 7MP α , 40B | |
| 12 | 2 | 81600157 | PIN, PLUNGER, LC, 7MP α , 40B | |
| 13 | 1 | 81600282 | PIVOT, TL360-TWIN, 2600 LB | |
| 14 | 2 | 81600285 | COVER, PIVOT, TL360-TWIN, 2600 LB | |
| 15 | 1 | 81600294 | PLUNGER, TL360-TWIN, 2600 LB | |
| N/A | N/A | 60160214 | KIT, SEAL, | NOTED |

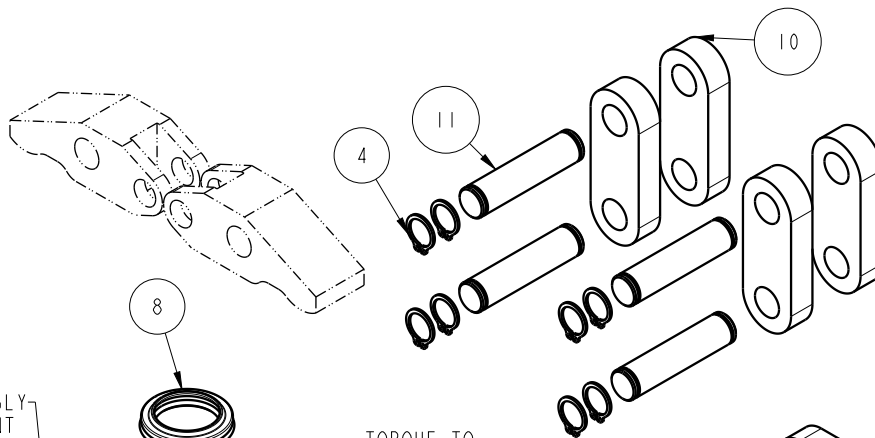

GREASE PACKET INCLUDED IN SEAL KIT

BODY SUB ASSEMBLY NOT A REPLACEMENT PART

TORQUE TO 87 IN-LB/7.2 Nm
TORQUE WHILE CLAMPING OVER WORKPIECE AT OPERATION PRESSURE

TORQUE TO 13 IN-LB/1.48 Nm
APPLY MEDIUM STRENGTH THREAD-LOCKER

PARTS LIST



VEKTEK, INC.
1334 E. SIXTH AVE. P.O. BOX 625
EMPORIA, KS. 66801 U.S.A.

ASSEMBLIES AFFECTED
41622240

PARTS LIST, ASSY, LC, CM, TL360-TWIN, DA, 11.57 kW

SIZE A
MPL1633

REV A

| | | | | |
|---------|------------------------|--|------------|-----------|
| A | 4723 | RELEASE | BDC | 7/19/2022 |
| REV | IN ACCORDANCE WITH ECN | EFFECTIVE DATE | REVISED BY | DATE |
| DRW BY: | BDC | DRAWING STATUS: Released | | |
| DATE: | 07/20/22 | PRODUCTION APPROVED FOR RELEASED STATUS ONLY | | |

FORM FEG035_PL_ASIZE, REV. B

SHEET 1 OF 1