

# Prefix-000046-Suffix

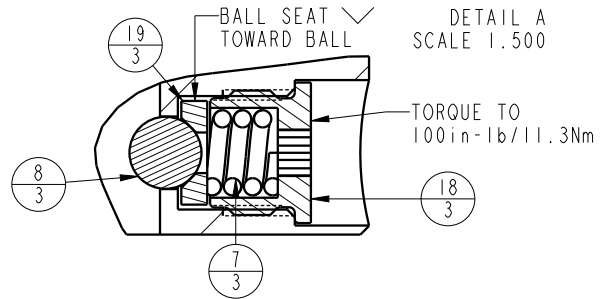

APPLY LUBRICANT TO ALL SEALS  
PRIOR TO INSTALLATION.  
DO NOT USE SILICONE TYPE LUBRICANTS.

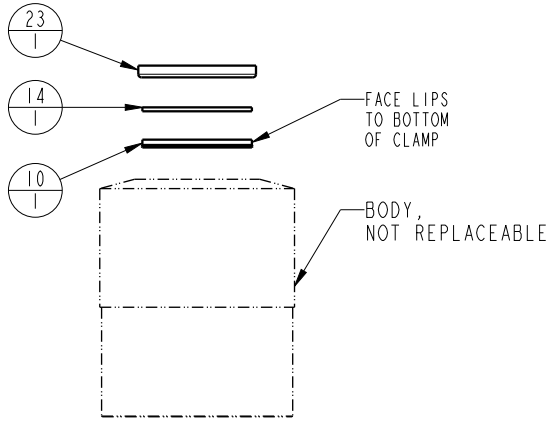
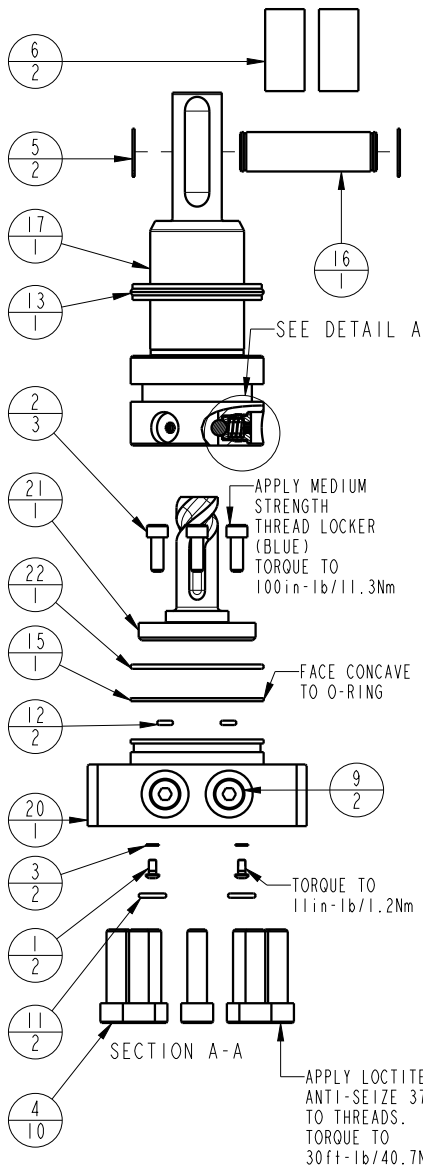

No.	QTY	PART No.	DESCRIPTION	INCLUDED IN KIT	
N/A	N/A	6V711044	SEAL KIT, FKM	INCLUDED IN KIT	
N/A	N/A	60711044	SEAL KIT, STANDARD		
23	1	39V11051	WIPER,PRESS-IN, (1-1/2)	X	X
22	1	39H51002	O-RING, (-033)	X	39V51002
21	1	81592121	CAM, RIGHT HAND		
		81592122	CAM, LEFT HAND		
		81592123	CAM, STRAIGHT		
		81592126	CAM, RIGHT HAND, LONG STROKE		
		81592127	CAM, LEFT HAND, LONG STROKE		
		81592128	CAM, STRAIGHT, LONG STROKE		
20	1	81542103	BASE, SC, BF, LP, 7500		
19	3	81532108	SEAT, BALL, SC, LP, TC		
18	3	81532107	RETAINER, SC, LP, TC		
17	1	81512113	PLUNGER,SC,LP,7500&33KN,CLEVIS		
		81512114	PLUNGER,SC,LP,7500&33KN,CLEVIS, LS		
16	1	81400275	PIN, ROCKER, SC, 7MP $\alpha$ , 63B		
15	1	39054017	BU RING,(-033)	X	39054023
14	1	39054016	BU RING,(1.5x.125x.063)	X	X
13	1	39052030	SEAL,CROWN,1-3/4x2-1/8x1/4	X	39V52030
12	2	39051041	O-RING, (-006)	X	39V51041
11	2	39050042	O-RING, (-011)	X	39051025
10	1	39011075	SEAL, LOADED LIP	X	39V11075
9	2	30601144	PLUG, SOCH, SAE 4		
8	3	23650004	BALL,TUNGSTEN-CARBIDE.250		
7	3	23350066	SPRING, COMPRESSION		
6	2	23340005	STOCK, CORD, .63 X 1.31, 50, NBR		
5	2	23050024	RING, RTNG, EXT, 0.625		
4	10	21500305	SHCS, M8 X 1,25-6G X 30MM		
3	2	21500200	WASHER		
2	3	21500031	SHCS, M5 x 0,8 x 14, ALY		
1	2	21500019	SCREW, CAP, BTNH, M3 X 6, ALY		
No.	QTY	PART No.	DESCRIPTION		

## PARTS LIST



VEKTEK, INC.  
1334 E. SIXTH AVE. P.O. BOX 625  
EMPORIA, KS. 66801 U.S.A.

**PARTS LIST, SC, LP, TC, BF, 8800, CLEVIS**

SIZE  
A **PL1467**

REV  
A

SHEET 1 OF 1

FORM FEG035\_PL\_ASIZE, REV. B

A	5867	RELEASE	NPETERS	12/11/25
REV	IN ACCORDANCE WITH ECN	EFFECTIVE DATE	REVISED BY	DATE
DRW BY:	NPETERS	<b>DRAWING STATUS: Released</b>		
DATE:	12/4/25	PRODUCTION APPROVED FOR RELEASED STATUS ONLY		

ASSEMBLIES AFFECTED  
14-2221-20, 14-2221-21  
14-2221-22, 14-2221-23  
14-2221-24, 14-2221-25