

THIS IS A TWO PAGE PARTS LIST.
THIS FIRST PAGE APPLIES TO
ASSEMBLY REVISION C AND LATER.

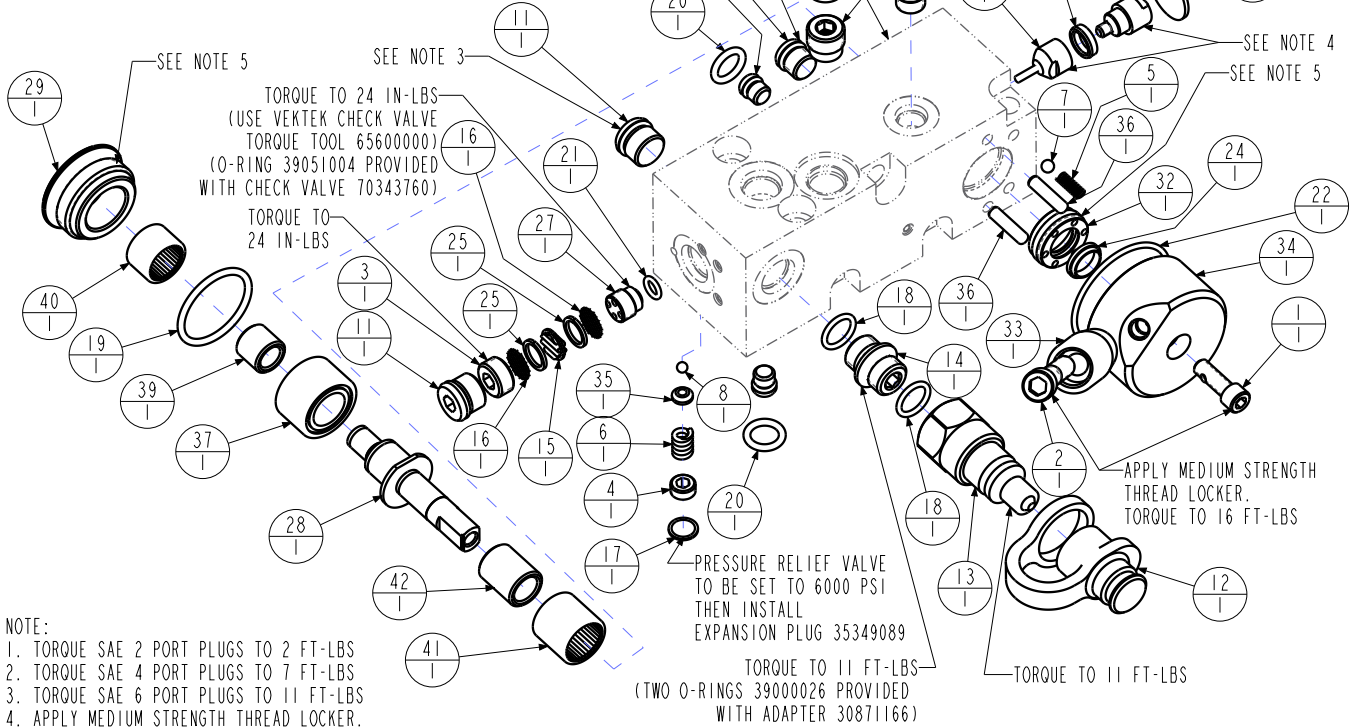

NO	QTY	PART NO	DESCRIPTION	KIT
1	1	21411031	SCREW, CAP, SOCH, 1/4-28 X 3/4, ALY, SLFLKG	
2	1	21411040	SCREW, CAP, SOCH, 5/16-18 X 2, ALY	
3	1	21440014	SHSS, HOLLOW	
4	1	21440024	SHSS, HOLLOW	
5	1	23310014	SPRING, COMPRESSION	X
6	1	23350057	SPRING, COMPRESSION	
7	1	23600011	BALL, STEEL, ALLOY, .187	X
8	1	23600014	BALL, STEEL, ALLOY, .156	
9	4	27412011	PLUG, EXPANSION, PULL-TYPE, 5mm	
10	2	30601144	PLUG, SOCH, SAE 4	
11	3	30601166	PLUG, SOCH, SAE 6	
12	1	30719706	COVER, DUST, OD, SAE 6	
13	1	30772766	COUPLING, OD, SAE 6, MALE	
14	1	30871166	ASSY, ADAPTER, SAE 6, MALE	
15	1	31050011	FILTER, DISC, SAE 6.25 MICRON	X
16	2	31050013	DIFFUSER, DISK, SAE 6	
17	1	35349089	EXPANSION PLUG	
18	2	39000026	O-RING, (-906)	X
19	1	39001057	O-RING, (-123)	X
20	2	39050046	O-RING, (-111)	X
21	1	39051004	O-RING, (-010)	X
22	1	39051077	O-RING, (43mm x 2)	X
23	1	39052017	SEAL, U-CUP, 3/8 x 1/8 x 1/2	X
24	1	39053004	WIPER, SNAP-IN, (7/16)	X

NO	QTY	PART NO	DESCRIPTION	KIT
25	2	39054010	BU RING, (-012)	X
26	1	70043771	ASSY, FILTER, IN-PORT, SAE 6.25 MICRON	X
27	1	70343760	VALVE, CHECK, SAE 4, 30 PSI	X
28	1	85600002	CAMSHAFT, PD, AUTOSHUTOFF	
29	1	85600003	RETAINER, PD, AUTOSHUTOFF	
30	1	85600006	PISTON, REAR, AUTOSHUTOFF, PD, SA	
31	1	85600007	PISTON, FRONT, AUTOSHUTOFF, PD, SA	
32	1	85600009	RETAINER, WIPER, PD, AUTOSHUTOFF	
33	1	85600012	HANDLE, PD, AUTOSHUTOFF	
34	1	85600013	HUB, AUTOSHUTOFF, PD, SA	
35	1	85600514	DISK, PD, DUAL, 5000	
36	2	90199943	PIN, DOWEL, 3/16 X 3/4, STD, SST, HDN	
37	1	90199949	BEARING, NEEDLE, 15 MM	
38	1	90199963	PLUG, EXPANSION, AL, 7/8	
39	1	90199965	RING, INNER, BEARING, NEEDLE, 3/8	
40	1	90199966	BEARING, NEEDLE, 9/16	
41	1	90199967	BEARING, NEEDLE, 5/8	
42	1	90199968	RING, INNER, BEARING, NEEDLE, 7/16	
N/A	N/A	62560012	KIT, REPAIR, PD, AUTOSHUTOFF, REV C AND LATER	NOTED

PARTS LIST



VEKTEK, INC.
1334 E. SIXTH AVE. P.O. BOX 625
EMPORIA, KS. 66801 U.S.A.

H	5038	RELEASE	JDW	02/21/23
REV	IN ACCORDANCE WITH ECN	EFFECTIVE DATE	REVISED BY	DATE
DRW BY:	JDW	DRAWING STATUS: Released		
DATE:	05/30/15	PRODUCTION APPROVED FOR RELEASED STATUS ONLY		

ASSEMBLIES AFFECTED
56-0006-06
56-0006-07

PARTS LIST, ASSY, PD, AUTOSHUTOFF	
SIZE A	PL5632
REV H	

**THIS IS A TWO PAGE PARTS LIST.
THIS SECOND PAGE APPLIES TO
ASSEMBLY REVISION B AND EARLIER.**

SEE NOTE 3
TORQUE TO 24 IN-LBS
(USE VEKTEK CHECK VALVE TORQUE TOOL 65600000)
(O-RING 39051004 PROVIDED WITH CHECK VALVE 70343760)

SEE NOTE 5
TORQUE TO 24 IN-LBS

NOTE:

1. TORQUE SAE 2 PORT PLUGS TO 2 FT-LBS
2. TORQUE SAE 4 PORT PLUGS TO 7 FT-LBS
3. TORQUE SAE 6 PORT PLUGS TO 11 FT-LBS
4. APPLY MEDIUM STRENGTH THREAD LOCKER TO THREADS.
TIGHTEN FRONT & REAR PISTONS TOGETHER AT 11 IN-LBS TORQUE.
5. APPLY LOW STRENGTH THREAD LOCKER. TORQUE TO 12 FT-LBS.

BODY, NON-REPLACEMENT ITEM

SEE NOTE 1

SEE NOTE 2

SEE NOTE 4

SEE NOTE 5

APPLY MEDIUM STRENGTH
THREAD LOCKER.
TORQUE TO 16 FT-LBS

PRESSURE RELIEF VALVE
TO BE SET TO 6000 PSI
THEN INSTALL
EXPANSION PLUG 35349089

TORQUE TO 11 FT-LBS
(TWO O-RINGS 39000026 PROVIDED
WITH ADAPTER 30871166)

TORQUE TO 11 FT-LBS

NO	QTY	PART NO	DESCRIPTION	KIT
1	1	21411031	SCREW,CAP,SOCH,1/4-28 X 3/4,ALY,SLFLKG	
2	1	21411040	SCREW, CAP, SOCH, 5/16-18 X 2, ALY	
3	1	21440014	SHSS, HOLLOW	
4	1	21440024	SHSS, HOLLOW	
5	1	23310014	SPRING, COMPRESSION	X
6	1	23350057	SPRING, COMPRESSION	
7	1	23600011	BALL, STEEL, ALLOY, .187	X
8	1	23600014	BALL, STEEL, ALLOY, .156	
9	2	30601122	PLUG, SOCH, SAE 2	
10	2	30601144	PLUG, SOCH, SAE 4	
11	2	30601166	PLUG, SOCH, SAE 6	
12	1	30719706	COVER, DUST, OD, SAE 6	
13	1	30772766	COUPLING, OD, SAE 6, MALE	
14	1	30871166	ASSY, ADAPTER, SAE 6, MALE	
15	2	31050011	FILTER,DISC,SAE 6,25 MICRON	X
16	4	31050013	DIFFUSER, DISK, SAE 6	
17	1	35349089	EXPANSION PLUG	
18	2	39000026	O-RING, (-906)	X
19	1	39001057	O-RING, (-123)	X
20	2	39050046	O-RING, (-111)	X
21	1	39051004	O-RING, (-010)	X
22	1	39051077	O-RING, (43mm x 2)	X
23	1	39052017	SEAL, U-CUP, 3/8 x 1/8 x 1/2	X
24	1	39053004	WIPER,SNAP-IN, (7/16)	X

NO	QTY	PART NO	DESCRIPTION	KIT
25	4	39054010	BU RING,(-012)	X
26	1	70343760	VALVE, CHECK, SAE 4, 30 PSI	X
27	1	85600002	CAMSHAFT,PD,AUTOSHUTOFF	
28	1	85600003	RETAINER,PD,AUTOSHUTOFF	
29	1	85600006	PISTON, REAR, AUTOSHUTOFF, PD, SA	
30	1	85600007	PISTON,FRONT,AUTOSHUTOFF,PD,SA	
31	1	85600009	RETAINER,WIPER,PD,AUTOSHUTOFF	
32	1	85600012	HANDLE, PD, AUTOSHUTOFF	
33	1	85600013	HUB, AUTOSHUTOFF, PD, SA	
34	1	85600014	DISK, PD, DUAL, 5000	
35	2	90199943	PIN, DOWEL, 3/16 X 3/4, STD, SST, HDN	
36	1	90199949	BEARING, NEEDLE, 15 MM	
37	1	90199963	PLUG, EXPANSION, AL, 7/8	
38	1	90199965	RING, INNER, BEARING, NEEDLE, 3/8	
39	1	90199966	BEARING, NEEDLE, 9/16	
40	1	90199967	BEARING, NEEDLE, 5/8	
41	1	90199968	RING, INNER, BEARING, NEEDLE, 7/16	
N/A	N/A	62560010	KIT, REPAIR, PD, AUTOSHUTOFF, REV B AND EARLIER	NOTED

PARTS LIST



VEKTEK, INC.
1334 E. SIXTH AVE. P.O. BOX 625
EMPORIA, KS. 66801 U.S.A.

H	5038	RELEASE	JDW	02/21/23
REV	IN ACCORDANCE WITH ECN	EFFECTIVE DATE	REVISED BY	DATE
DRW BY:	JDW	DRAWING STATUS: Released		
DATE:	05-30-15	PRODUCTION APPROVED FOR RELEASED STATUS ONLY		

ASSEMBLIES AFFECTED
56000606
56000607

PARTS LIST, ASSY,PD,AUTOSHUTOFF	
SIZE A	PL5632
REV H	

FORM FEG035_PL.A.SIZE, REV. B

SHEET 2 OF 2