

| NO | QTY | PART NO | DESCRIPTION | FILTER KIT | SEAL KIT |
|-----|-----|----------|--|------------|----------|
| 1 | 2 | 21410063 | S.H.C.S. 1/4-20 UNC X .50 LG. | | |
| 2 | 1 | 21440014 | SHSS, HOLLOW | | |
| 3 | 2 | 23002013 | RETAINING RING, INTERNAL, 13 MM | X | |
| 4 | 8 | 30601166 | PLUG, SOCH, SAE 6 | | |
| 5 | 2 | 30603322 | PLUG, PIPE, HEX, HOL, 1/8 NPT, STEEL | | |
| 6 | 3 | 30772766 | COUPLING, QD, SAE 6, MALE | | |
| 7 | 3 | 30871166 | ASSY, ADAPTER, SAE 6, MALE | | |
| 8 | 3 | 31050011 | FILTER, DISC, SAE 6, 25 MICRON | X | |
| 9 | 6 | 31050013 | DIFFUSER, DISK, SAE 6 | X | |
| 10 | 3 | 39000021 | O-RING, (-018) | | X |
| 11 | 6 | 39000026 | O-RING, (-906) | | X |
| 12 | 1 | 39000030 | O-RING, (-014) | | X |
| 13 | 1 | 39000031 | O-RING, (-012) | | X |
| 14 | 1 | 39000036 | O-RING, (-908) | | X |
| 15 | 8 | 39054010 | BU RING, (-012) | X | X |
| 16 | 1 | 55250001 | O-RING, (-010) | | X |
| 17 | 1 | 56000703 | ASSY, PD COVER, 2H, VEKTEK | | |
| 18 | 1 | 70343792 | VALVE, CHECK, SAE 4, 30 PSI | | |
| 19 | 1 | 85600519 | COVER, PD, 2H, DUAL, EXT ACC | | |
| 20 | 1 | 85600539 | PLUG, PD, PISTON, SAE 6 | | |
| 21 | 1 | 87033103 | PISTON, AB, PILOT CHK. | | |
| 22 | 1 | 90199986 | PD COVER, LEASH, #10 BALL CHAIN | | |
| N/A | N/A | 60560002 | KIT, SEAL, PD, 2H, DUAL, PNEU | N/A | NOTED |
| N/A | N/A | 62560007 | KIT, FILTER, PD, DUAL, 25 MICRON | NOTED | N/A |
| N/A | N/A | 62560008 | KIT, TOOL, SERVICE, PD, CHK VLV & FILTER | N/A | N/A |

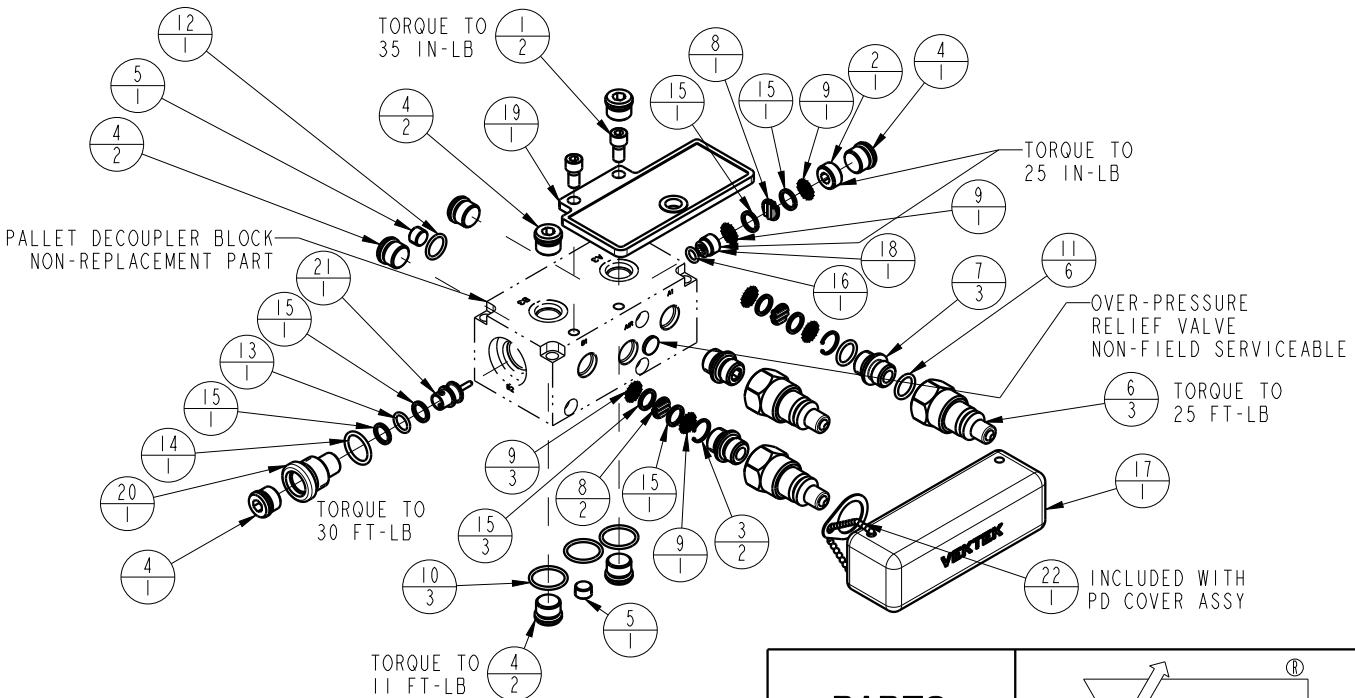

NOTES:
 1. APPLY LUBRICANT TO ALL SEALS PRIOR TO INSTALLATION
 2. DO NOT USE SILICONE TYPE LUBRICANTS.
 3. PD SERVICE TOOL KIT INCLUDES CHK VLV WRENCH (65600000) AND LONG 1/4" HEX KEY (65600001).

| | | |
|---------------------------------|--|----------|
| PARTS LIST | | |
| | VEKTEK, INC. 1334 E. SIXTH AVE. P.O. BOX 625 EMPORIA, KS. 66801 U.S.A. | |
| ASSEMBLIES AFFECTED 56000544 | PARTS LIST, ASSY, PD, 2H, DUAL, PNEU | |
| SIZE A | PL5644 | REV A |

| | | | | |
|---------------|--|----------------|------------|---------|
| A | 4352 | RELEASE | ALS | 10/6/20 |
| REV | IN ACCORDANCE WITH ECN | EFFECTIVE DATE | REVISED BY | DATE |
| DRW BY: ALS | DRAWING STATUS: Released | | | |
| DATE: 10/6/20 | PRODUCTION APPROVED FOR RELEASED STATUS ONLY | | | |